

DEMO & CLEARING GENERAL NOTES:

1. ALL BASE ESC MEASURES MUST BE IN PLACE, FUNCTIONAL, COMPLY WITH CURRENT ODOT SPECIFICATIONS, AND APPROVED IN AN INITIAL INSPECTION, PRIOR TO COMMENCEMENT OF CONSTRUCTION ACTIVITIES.
2. NO ACTIVITIES ARE PERMITTED TO OCCUR BEYOND THE LIMITS OF DISTURBANCE.
3. ADDITIONAL MEASURES INCLUDING, BUT NOT LIMITED TO, STREET SWEEPING, AND VACUUMING, MAY BE REQUIRED TO INSURE THAT ALL PAVED AREAS ARE KEPT CLEAN FOR THE DURATION OF THE PROJECT.
4. RUN-ON AND RUN-OFF CONTROLS SHALL BE IN PLACE AND FUNCTIONING FOR THE DURATION OF THE PROJECT, RUN-ON AND RUN-OFF CONTROL MEASURES INCLUDE: CHECK DAMS, SURFACE ROUGHENING AND BANK STABILIZATION.
5. SENSITIVE RESOURCES INCLUDING, BUT NOT LIMITED TO, TREES, WETLANDS, AND RIPARIAN PROTECTION AREAS SHALL BE CLEARLY DELINEATED WITH ORANGE CONSTRUCTION FENCING OR CHAIN LINK FENCING IN A MANNER THAT IS CLEARLY VISIBLE TO ANYONE IN THE AREA. NO ACTIVITIES ARE PERMITTED TO OCCUR BEYOND THE CONSTRUCTION BARRIER.
6. CONTRACTOR SHALL COORDINATE WITH EPSC CERTIFIED VISUAL MONITORING INSPECTOR TO DETERMINE FINAL BMP TYPE AND PLACEMENT.
7. CONSTRUCTION WILL OCCUR DURING SUMMER MONTHS. DEWATERING IS NOT EXPECTED TO OCCUR. IF DEWATERING IS REQUIRED, DISCHARGE WATER TO ESTABLISHED VEGETATION IN UPLAND AREA.

**WET WEATHER REQUIREMENTS
(OCT. 15TH - APR. 30TH)**

1. GRAVEL CONSTRUCTION SITE ENTRANCES TO PROTECT ADJOINING ROADS AND WATERWAYS FROM VEHICLE TRACKING OFF OF THE SITE.
2. PROTECT ALL STORMWATER FACILITIES, WATER FEATURES AND NATURAL AREAS.
3. SEDIMENT, SOIL, OR CONSTRUCTION-RELATED MATERIAL MUST BE REMOVED IMMEDIATELY FROM RIGHT-OF-WAY, ADJOINING PROPERTY AND NATURAL RESOURCES.

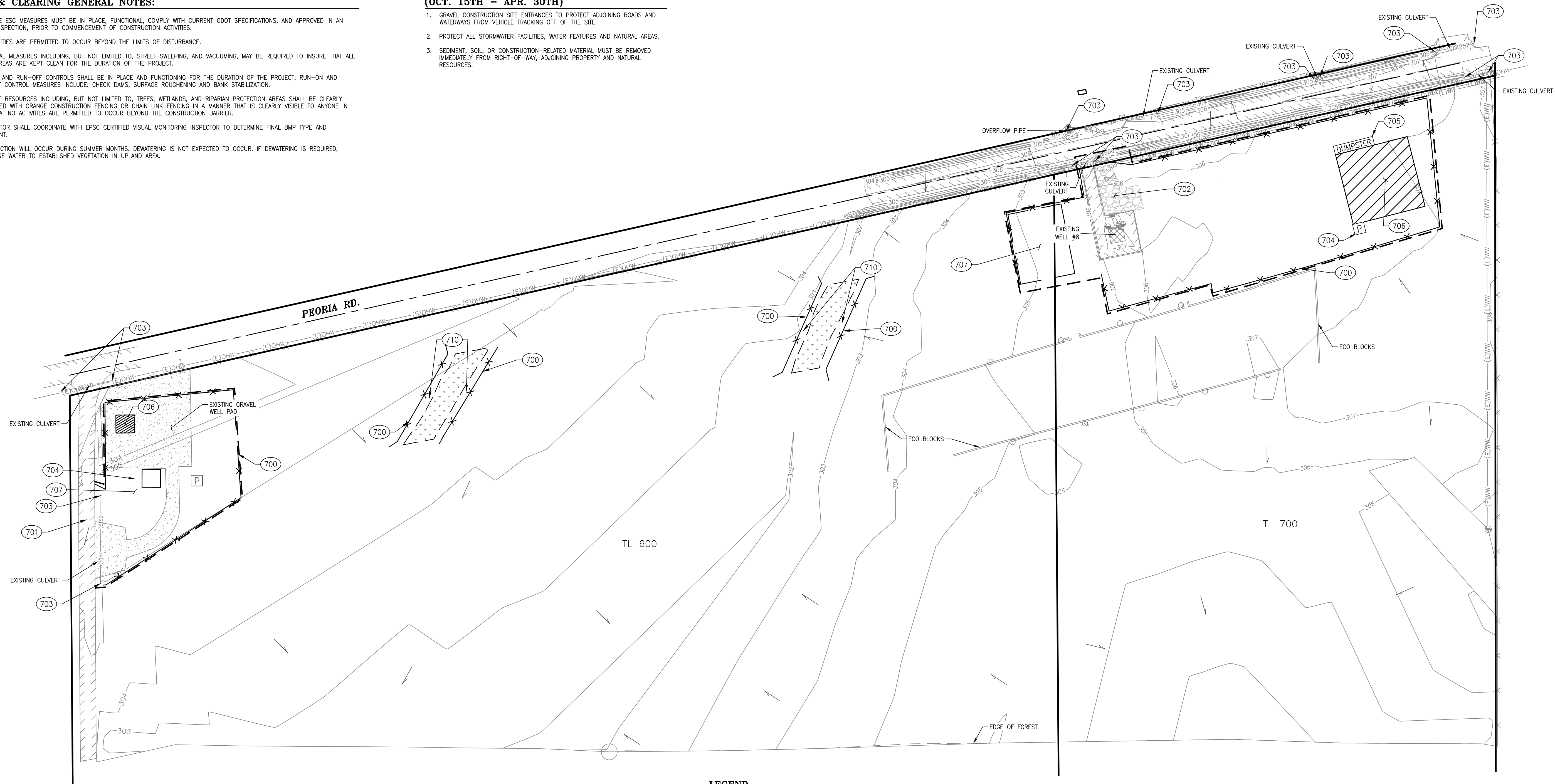

ESC CONSTRUCTION NOTES

- | | | | |
|-----|--|-----|---|
| 700 | INSTALL ORANGE SEDIMENT/CONSTRUCTION FENCE AT LIMITS OF DISTURBANCE WHERE NECESSARY TO LIMIT SEDIMENT DRAINING OUT FROM PROJECT SITE. INSTALLATION OF BMP PER OREGON STANDARD DRAWING RD1040, SEE SHEET EC400. | 707 | TEMPORARY AREA FOR EQUIPMENT AND MATERIAL STORAGE AND STAGING, STORAGE OF HAZARDOUS WASTE AND FUEL, AND EQUIPMENT REFUELING AND MAINTENANCE. SEE SPILL PREVENTION AND CONTROL NOTES ON SHEET EC000. |
| 701 | USE EXISTING PAVED ACCESS AS CONSTRUCTION ENTRANCE/EXIT. ENSURE EXISTING ACCESS MEETS REQUIREMENTS SHOWN IN OREGON STANDARD DRAWING RD1000, SHEET EC400. | 708 | CONSTRUCT CONCRETE TRUCK WASH OUT PER OREGON STANDARD DRAWING RD1070 ON SHEET EC401. |
| 702 | CONSTRUCT CONSTRUCTION ENTRANCE/EXIT TYPE 1 PER OREGON STANDARD DRAWING RD1000, SHEET EC400. | 710 | CONTRACTOR SHALL NOT DISTURB ANY AREA WITHIN 10' OF DELINEATED WETLAND BOUNDARY. |
| 703 | INSTALL TYPE 4 INLET PROTECTION FOR CULVERT INLETS PER OREGON STANDARD DRAWING RD1015, SHEET EC400. | | |
| 704 | PROVIDE AND MAINTAIN PORTABLE TOILETS PER OSHA STANDARDS. FINAL LOCATION TBD BY CONTRACTOR. | | |
| 705 | PROVIDE DUMPSTER CONTAINERS FOR CONSTRUCTION DEBRIS. FINAL LOCATION TBD BY CONTRACTOR. | | |
| 706 | TEMPORARY STOCKPILE LOCATION. INSTALL PLASTIC SHEETING ON STOCKPILE PER ODOT TECHNICAL SERVICES DET6001, SHEET EC401. | | |

LEGEND

	PROPERTY LINE		LIMITS OF DISTURBANCE
	EDGE OF ASPHALT		PROPOSED STAGING AREA
	FENCE		ORANGE SILT FENCE
	BOTTOM OF DITCH		PROPOSED STOCKPILE AREA
	TOP OF BANK		PROPOSED CONCRETE WASHOUT
	BUILDING OR STRUCTURE		GRAVEL CONSTRUCTION ENTRANCE
	WATER METER		
	FIRE HYDRANT		
	WATER VALVE		
	POWER POLE		
	WASTE WATER MANHOLE		
	TELEPHONE RISER		
	GRAVEL		
	EXISTING DIRECTION OF FLOW		

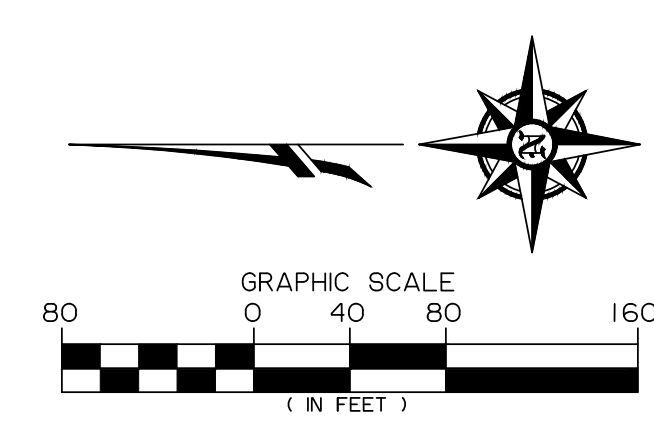

Z:\2020\20-0028 Harrisburg WTP_Site\1\200-C\Drawings\20-0028-1\200-C_Plan_EC100.dwg 6/4/2024 4:05 PM ZHARTAZ

NO.	DATE	BY	REVISION

NOTICE

0 1/2 1

IF THIS BAR DOES NOT MEASURE 1" THEN DRAWING IS NOT TO SCALE

JLL
DESIGNED
ZZ
DRAWN
DG
CHECKED



WTP DESIGN NORTH & SOUTH

TAX MAP: 15S04W04 TAX LOT: 600
TAX MAP: 15S04W09 TAX LOT: 700

**EPSCP: NORTH WTP SITE
DEMOLITION & CLEARING**

PROJECT NO.: 20-0028.300 SCALE: AS SHOWN DATE: JUNE 2024

SHEET
EC100

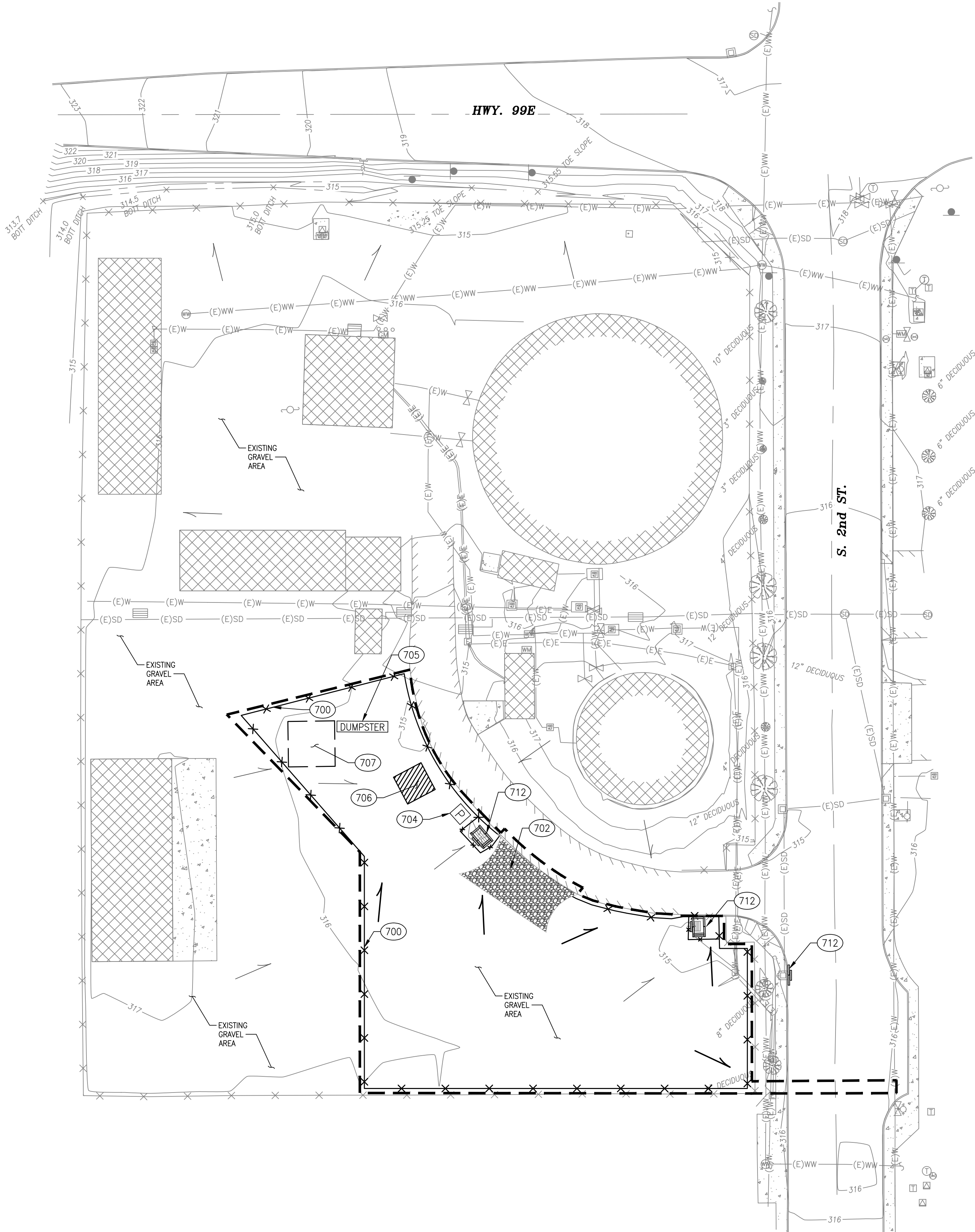

ESC CONSTRUCTION NOTES

- 700 INSTALL ORANGE SEDIMENT/CONSTRUCTION FENCE AT LIMITS OF DISTURBANCE WHERE NECESSARY TO LIMIT SEDIMENT DRAINING OUT FROM PROJECT SITE. INSTALLATION OF BMP PER OREGON STANDARD DRAWING RD1040, SEE SHEET EC400.
- 702 CONSTRUCT CONSTRUCTION ENTRANCE/EXIT TYPE 1 PER OREGON STANDARD DRAWING RD1000, SHEET EC400.
- 704 PROVIDE AND MAINTAIN PORTABLE TOILETS PER OSHA STANDARDS. FINAL LOCATION TBD BY CONTRACTOR.
- 705 PROVIDE DUMPSTER CONTAINERS FOR CONSTRUCTION DEBRIS. FINAL LOCATION TBD BY CONTRACTOR.
- 706 TEMPORARY STOCKPILE LOCATION. INSTALL PLASTIC SHEETING ON STOCKPILE PER ODOT TECHNICAL SERVICES DET6001, SHEET EC401.
- 707 TEMPORARY AREA FOR EQUIPMENT AND MATERIAL STORAGE AND STAGING, STORAGE OF HAZARDOUS WASTE AND FUEL, AND EQUIPMENT REFUELING AND MAINTENANCE. SEE SPILL PREVENTION AND CONTROL NOTES ON SHEET EC000.
- 712 INSTALL INLET PROTECTION TYPE 4 PER OREGON STANDARD DRAWING RD1015, SEE SHEET EC400.

LEGEND

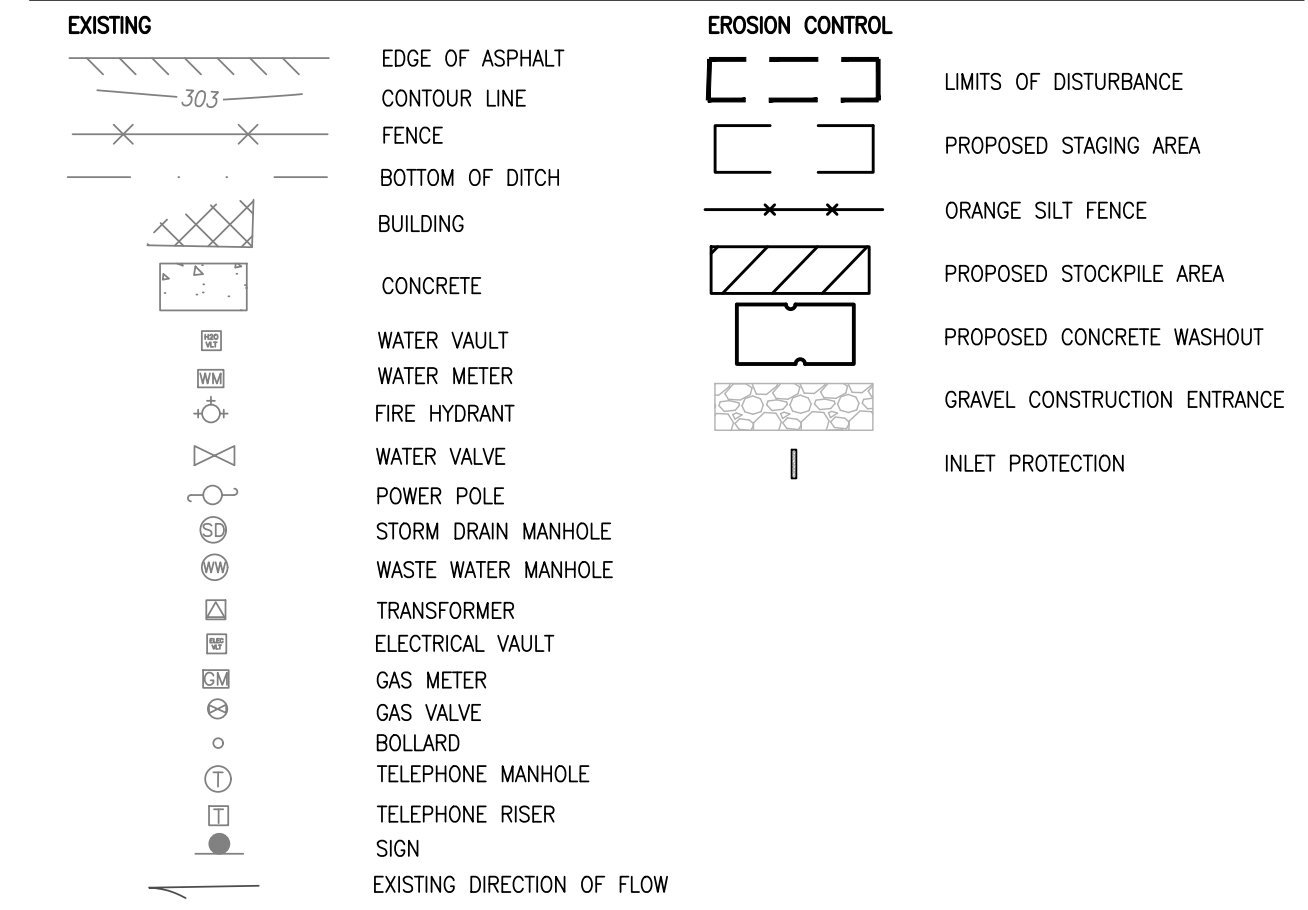

DEMO & CLEARING GENERAL NOTES:

1. ALL BASE ESC MEASURES MUST BE IN PLACE, FUNCTIONAL, COMPLY WITH CURRENT ODOT SPECIFICATIONS, AND APPROVED IN AN INITIAL INSPECTION, PRIOR TO COMMENCEMENT OF CONSTRUCTION ACTIVITIES.
2. NO ACTIVITIES ARE PERMITTED TO OCCUR BEYOND THE LIMITS OF DISTURBANCE.
3. ADDITIONAL MEASURES INCLUDING, BUT NOT LIMITED TO, STREET SWEEPING, AND VACUUMING, MAY BE REQUIRED TO INSURE THAT ALL PAVED AREAS ARE KEPT CLEAN FOR THE DURATION OF THE PROJECT.
4. RUN-ON AND RUN-OFF CONTROLS SHALL BE IN PLACE AND FUNCTIONING FOR THE DURATION OF THE PROJECT. RUN-ON AND RUN-OFF CONTROL MEASURES INCLUDE: CHECK DAMS, SURFACE ROUGHENING AND BANK STABILIZATION.
5. SENSITIVE RESOURCES INCLUDING, BUT NOT LIMITED TO, TREES, WETLANDS, AND RIPARIAN PROTECTION AREAS SHALL BE CLEARLY DELINEATED WITH ORANGE CONSTRUCTION FENCING OR CHAIN LINK FENCING IN A MANNER THAT IS CLEARLY VISIBLE TO ANYONE IN THE AREA. NO ACTIVITIES ARE PERMITTED TO OCCUR BEYOND THE CONSTRUCTION BARRIER.
6. CONTRACTOR SHALL COORDINATE WITH EPSC CERTIFIED VISUAL MONITORING INSPECTOR TO DETERMINE FINAL BMP TYPE AND PLACEMENT.
7. CONSTRUCTION WILL OCCUR DURING SUMMER MONTHS. DEWATERING IS NOT EXPECTED TO OCCUR. IF DEWATERING IS REQUIRED, DISCHARGE WATER TO ESTABLISHED VEGETATION IN UPLAND AREA.

WET WEATHER REQUIREMENTS (OCT. 15TH - APR. 30TH)

1. GRAVEL CONSTRUCTION SITE ENTRANCES TO PROTECT ADJOINING ROADS AND WATERWAYS FROM VEHICLE TRACKING OFF OF THE SITE.
2. PROTECT ALL STORMWATER FACILITIES, WATER FEATURES AND NATURAL AREAS.
3. SEDIMENT, SOIL, OR CONSTRUCTION-RELATED MATERIAL MUST BE REMOVED IMMEDIATELY FROM RIGHT-OF-WAY, ADJOINING PROPERTY AND NATURAL RESOURCES.

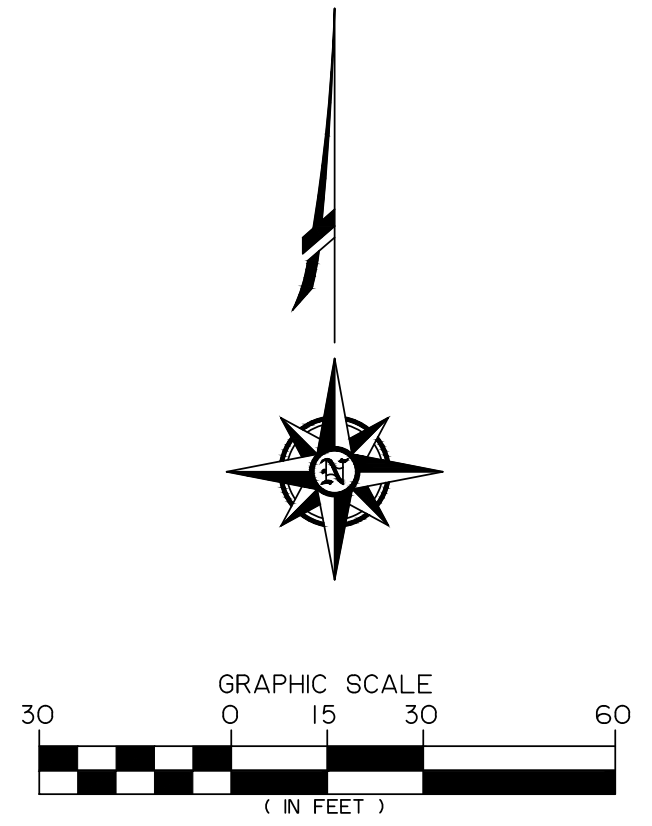

Z:\2020\20-006C Harrisburg WTP Site\1200-C Drawings\20-006C-1200-C PLAN_060324.dwg 6/4/2024 4:05 PM ZHARTAZ

NO.	DATE	BY	REVISION

NOTICE

IF THIS BAR DOES NOT MEASURE 1" THEN DRAWING IS NOT TO SCALE

JLL
DESIGNED
ZZ
DRAWN
DG
CHECKED

REGISTERED PROFESSIONAL ENGINEER
#86136PE
DIGITALLY SIGNED
OREGON
JULIE LYNN LELAND
JAN. 8. 2019
Expires: DEC 31, 2024

Branch ENGINEERING
210 5th Street
Springfield, OR 97477
p: 541.746.0637
www.BranchEngineering.com

WTP DESIGN NORTH & SOUTH
TAX MAP: 15S04W04 TAX LOT: 600
TAX MAP: 15S04W09 TAX LOT: 700

EPSCP: SOUTH WTP SITE DEMOLITION & CLEARING

PROJECT NO.: 20-0028.300 SCALE: AS SHOWN DATE: JUNE 2024

SHEET
EC101

GRADING, EXCAVATION & STREET CONSTRUCTION GENERAL NOTES:

- ALL BASE ESC MEASURES MUST BE IN PLACE, FUNCTIONAL, COMPLY WITH CURRENT ODOT SPECIFICATIONS, AND APPROVED IN AN INITIAL INSPECTION, PRIOR TO COMMENCEMENT OF CONSTRUCTION ACTIVITIES.
- NO ACTIVITIES ARE PERMITTED TO OCCUR BEYOND THE CONSTRUCTION BARRIER (PERIMETER SEDIMENT FENCE).
- ADDITIONAL MEASURES INCLUDING, BUT NOT LIMITED TO, STREET SWEEPING, AND VACUUMING, MAY BE REQUIRED TO INSURE THAT ALL PAVED AREAS ARE KEPT CLEAN FOR THE DURATION OF THE PROJECT.
- STOCKPILED SOIL OR STRIPPINGS SHALL BE PLACED IN A STABLE LOCATION AND CONFIGURATION. STOCKPILES SHALL BE COVERED WITH POLYETHYLENE PLASTIC SHEETING (6 MIL OR THICKER) OR STRAW MULCH. SEDIMENT FENCE IS REQUIRED AROUND THE PERIMETER OF THE STOCKPILE.
- SOIL MAY NOT BE STOCKPILED WITHIN TREE CRITICAL ROOT ZONES, IN DRAINAGE WAYS, STREET RIGHT-OF-WAYS, OR DRIVEWAYS THAT DRAIN TO THE STREET.
- EXPOSED CUT OR FILL AREAS SHALL BE STABILIZED THROUGH THE USE OF TEMPORARY SEEDING AND MULCHING, EROSION CONTROL BLANKETS OR MATS, MID-SLOPE SEDIMENT FENCES OR WATTLES, OR OTHER APPROPRIATE MEASURES.
- AREAS SUBJECT TO WIND EROSION SHALL USE APPROPRIATE DUST CONTROL MEASURES INCLUDING THE APPLICATION OF A FINE SPRAY OF WATER, PLASTIC SHEETING, STRAW MULCHING, OR OTHER APPROVED MEASURES.
- CONSTRUCTION ENTRANCES SHALL BE MAINTAINED FOR THE DURATION OF THE PROJECT. ADDITIONAL MEASURES INCLUDING, BUT NOT LIMITED TO, TIRE WASHES, STREET SWEEPING, AND VACUUMING MAY BE REQUIRED TO INSURE THAT ALL PAVED AREAS ARE KEPT CLEAN FOR THE DURATION OF THE PROJECT.
- ACTIVE INLETS TO STORM WATER SYSTEMS SHALL BE PROTECTED THROUGH THE USE OF APPROVED INLET PROTECTION MEASURES. ALL INLET PROTECTION MEASURES ARE TO BE REGULARLY INSPECTED AND MAINTAINED AS NEEDED.
- SATURATED MATERIALS THAT ARE HAULED OFF-SITE MUST BE TRANSPORTED IN WATER-TIGHT TRUCKS TO ELIMINATE SPILLAGE OF SEDIMENT AND SEDIMENT-LADEN WATER.
- CONTRACTOR SHALL HAVE A FRACTION MITIGATION CONTINGENCY PLAN FOR DIRECTIONAL DRILLING BEFORE THE START OF CONSTRUCTION.
- AN AREA SHALL BE PROVIDED FOR THE WASHING OUT OF CONCRETE TRUCKS IN A LOCATION THAT DOES NOT PROVIDE RUN-OFF THAT CAN ENTER THE STORM WATER SYSTEM. IF THE CONCRETE WASH-OUT AREA CAN NOT BE CONSTRUCTED GREATER THAN 50' FROM ANY DISCHARGE POINT, SECONDARY MEASURES SUCH AS BERMS OR TEMPORARY SETTLING PITS MAY BE REQUIRED. THE WASH-OUT SHALL BE LOCATED WITHIN SIX FEET OF TRUCK ACCESS AND BE CLEANED WHEN IT REACHES 50% OF THE CAPACITY.
- SWEEPINGS FROM EXPOSED AGGREGATE CONCRETE SHALL NOT BE TRANSFERRED TO THE STORM WATER SYSTEM. SWEEPINGS SHALL BE PICKED UP AND DISPOSED IN THE TRASH.
- AVOID PAVING IN WET WEATHER WHEN PAVING CHEMICALS CAN RUN-OFF INTO THE STORM WATER SYSTEM.
- USE BMPs SUCH AS CHECK-DAMS, BERMS, AND INLET PROTECTION TO PREVENT RUN-OFF FROM REACHING DISCHARGE POINTS.
- COVER CATCH BASINS, MANHOLES, AND OTHER DISCHARGE POINTS WHEN APPLYING SEAL COAT, TACK COAT, ETC. TO PREVENT INTRODUCING THESE MATERIALS TO THE STORM WATER SYSTEM.
- ROUTINE MAINTENANCE SPECIFICATIONS FOR PERIMETER CONTROLS DOCUMENTED IN THE EPSCP MUST INCLUDE SECTIONS 2.1.4, 2.1.5 AND 2.2.6 OF THE GENERAL PERMIT NPDES CONSTRUCTION STORMWATER DISCHARGE PERMIT.
- CONTRACTOR SHALL COORDINATE WITH EPSC CERTIFIED VISUAL MONITORING INSPECTOR TO DETERMINE FINAL BMP TYPE AND PLACEMENT.
- CONSTRUCTION WILL OCCUR DURING SUMMER MONTHS. DEWATERING IS NOT EXPECTED TO OCCUR. IF DEWATERING IS REQUIRED, DISCHARGE WATER TO ESTABLISHED VEGETATION IN UPLAND AREA.

SAW CUTTING

- DO NOT ALLOW SAW CUT SLURRY AND/OR RUNOFF TO ENTER STORM DRAINS OR WATER COURSES.
- RESCHEDULE SAW CUTTING IF RAINING OR RAIN IS IN THE FORECAST.
- PROTECT STORM INLETS PRIOR TO START OF WORK
- ALL WASTE GENERATED FROM SAW CUTTING SHALL BE VACUUMED IMMEDIATELY BEHIND THE SAW CUTTING OPERATION. DO NOT ALLOW SAW CUT SLURRY TO FLOW ACROSS THE PAVEMENT AND IT SHOULD NOT BE LEFT ON THE SURFACE OF THE PAVEMENT.
- DISPOSAL OF SAW CUTTING WASTE APPROPRIATELY.

WET WEATHER REQUIREMENTS (OCT. 15TH - APR. 30TH)

- GRAVEL CONSTRUCTION SITE ENTRANCES TO PROTECT ADJOINING ROADS AND WATERWAYS FROM VEHICLE TRACKING OFF OF THE SITE.
- PROTECT ALL STORMWATER FACILITIES, WATER FEATURES AND NATURAL AREAS.
- SEDIMENT, SOIL, OR CONSTRUCTION-RELATED MATERIAL MUST BE REMOVED IMMEDIATELY FROM RIGHT-OF-WAY, ADJOINING PROPERTY AND NATURAL RESOURCES.

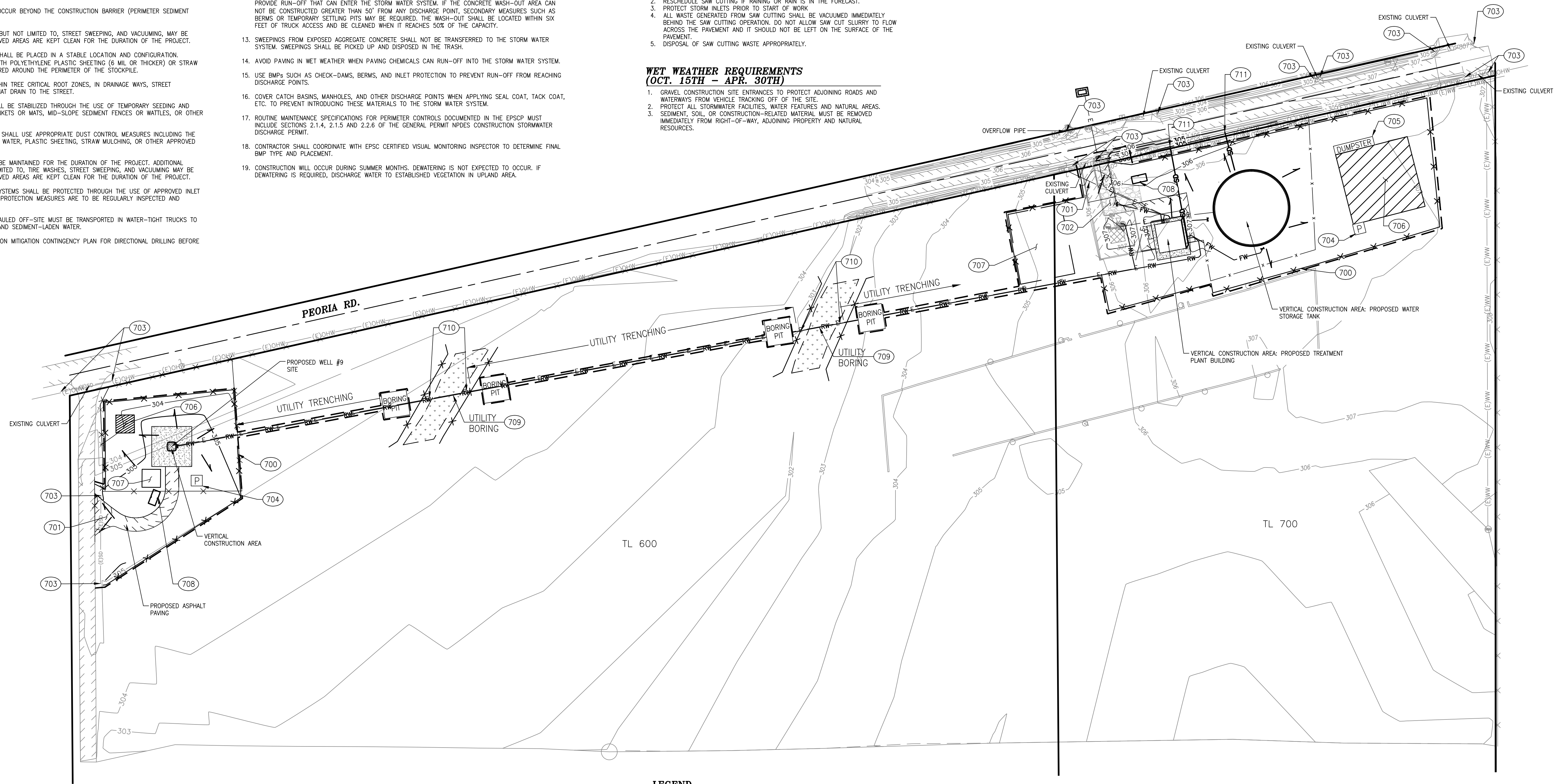

ESC CONSTRUCTION NOTES

- | | | | |
|-----|--|-----|--|
| 700 | INSTALL ORANGE SEDIMENT/CONSTRUCTION FENCE AT LIMITS OF DISTURBANCE WHERE NECESSARY TO LIMIT SEDIMENT DRAINING OUT FROM PROJECT SITE. INSTALLATION OF BMP PER OREGON STANDARD DRAWING RD1040, SEE SHEET EC400. | 707 | TEMPORARY AREA FOR EQUIPMENT AND MATERIAL STORAGE AND STAGING, STORAGE OF HAZARDOUS WASTE, AND FUEL, AND EQUIPMENT REFUELING AND MAINTENANCE. SEE SPILL PREVENTION AND CONTROL NOTES ON SHEET EC000. |
| 701 | USE EXISTING PAVED ACCESS AS CONSTRUCTION ENTRANCE/EXIT. ENSURE EXISTING ACCESS MEETS REQUIREMENTS SHOWN IN OREGON STANDARD DRAWING RD1000, SHEET EC400. | 708 | CONSTRUCT CONCRETE TRUCK WASH OUT PER OREGON STANDARD DRAWING RD1070 ON SHEET EC401. |
| 702 | CONSTRUCT CONSTRUCTION ENTRANCE/EXIT TYPE 1 PER OREGON STANDARD DRAWING RD1000, SHEET EC400. | 709 | MATERIALS REMOVED OR EXCAVATED DURING BORING SHALL BE DEPOSITED AWAY FROM EXISTING WETLAND, AND EITHER RETURNED TO THE TRENCH AS BACK-FILL, OR IF OTHER MATERIAL IS TO BE USED AS BACK-FILL IN THE TRENCH, EXCESS MATERIALS SHALL BE IMMEDIATELY REMOVED FROM THE PROTECTED RESOURCE AND ITS ASSOCIATED BUFFER. SIDE-CASTING OF REMOVED MATERIAL INTO A THE EXISTING WETLAND SHALL NOT BE PERMITTED. |
| 703 | INSTALL TYPE 4 INLET PROTECTION FOR CULVERT INLETS PER OREGON STANDARD DRAWING RD1015, SHEET EC400. | 710 | CONTRACTOR SHALL NOT DISTURB ANY AREA WITHIN 10' OF DELINEATED WETLAND BOUNDARY. |
| 704 | PROVIDE AND MAINTAIN PORTABLE TOILETS PER OSHA STANDARDS. FINAL LOCATION TBD BY CONTRACTOR. | 711 | PROVIDE OUTLET PROTECTION. INSTALL RIPRAP PAD PER OREGON STANDARD DRAWING RD317 ON SHEET EC400. |
| 705 | PROVIDE DUMPSTER CONTAINERS FOR CONSTRUCTION DEBRIS. FINAL LOCATION TBD BY CONTRACTOR. | | |
| 706 | TEMPORARY STOCKPILE LOCATION. INSTALL PLASTIC SHEETING ON STOCKPILE PER ODOT TECHNICAL SERVICES DETAIL DET6001, SHEET EC401. | | |

LEGEND

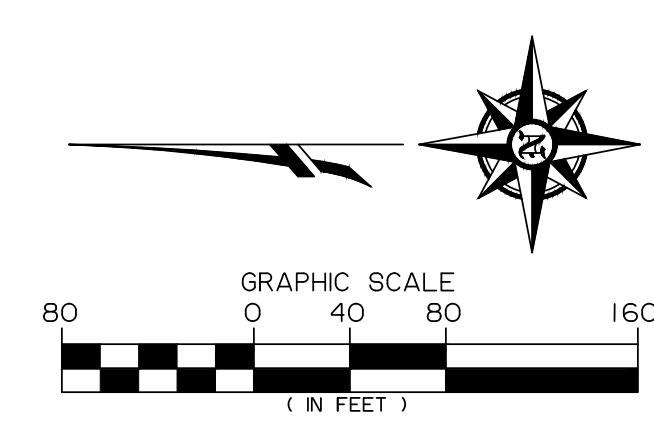
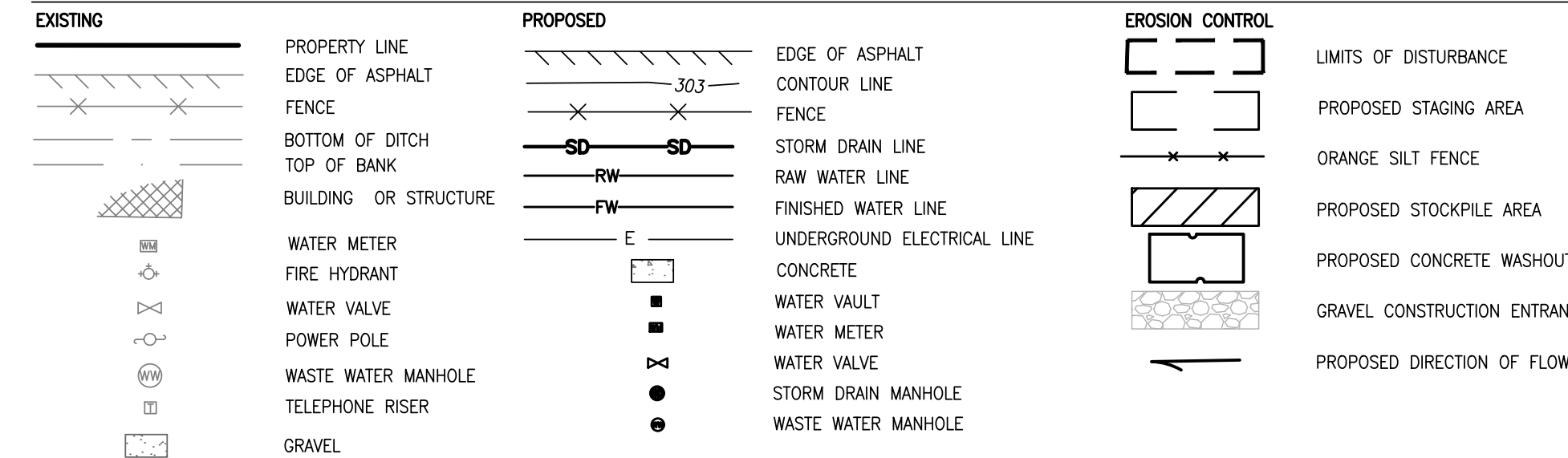

Z:\2020\20-0028-0006-Harrisburg WTP Site\1200-C\Drawings\20-0028-0006-1200-C-PLAN_060324.dwg 6/4/2024 4:06 PM ZHARTAZ

NO.	DATE	BY	REVISION

NOTICE

0 1/2 1

IF THIS BAR DOES NOT MEASURE 1" THEN DRAWING IS NOT TO SCALE

JLL
DESIGNED
ZZ
DRAWN
DG
CHECKED

REGISTERED PROFESSIONAL ENGINEER
#86136PE
DIGITALLY SIGNED
JULIE LYNN LELAND
JAN. 8. 2015

Expires: DEC 31, 2024

consor

Branch ENGINEERING
210 5th Street
Springfield, OR 97477
p: 541.748.0637
www.BranchEngineering.com

CITY OF HARRISBURG
Established 1866

WTP DESIGN NORTH & SOUTH
TAX MAP: 15S04W04 TAX LOT: 600
TAX MAP: 15S04W09 TAX LOT: 700

**EPSCP: NORTH WTP SITE
GRADING, EXCAVATING, UTILITIES
& VERTICAL CONSTRUCTION**

PROJECT NO.: 20-0028.300 SCALE: AS SHOWN DATE: JUNE 2024

SHEET
EC200

FINAL LANDSCAPING AND SITE STABILIZATION GENERAL NOTES:

- ALL BASE ESC MEASURES MUST BE IN PLACE, FUNCTIONAL, COMPLY WITH CURRENT ODOT SPECIFICATIONS, AND APPROVED IN AN INITIAL INSPECTION, PRIOR TO COMMENCEMENT OF CONSTRUCTION ACTIVITIES.
- NO ACTIVITIES ARE PERMITTED TO OCCUR BEYOND THE CONSTRUCTION BARRIER (PERIMETER SEDIMENT FENCE).
- CONSTRUCTION ENTRANCES SHALL BE MAINTAINED FOR THE DURATION OF THE PROJECT. ADDITIONAL MEASURES INCLUDING, BUT NOT LIMITED TO, STREET SWEEPING, AND W/QUJMING, MAY BE REQUIRED TO INSURE THAT ALL PAVED AREAS ARE KEPT CLEAN FOR THE DURATION OF THE PROJECT.
- SEED USED FOR TEMPORARY OR PERMANENT SEEDING PER SEED MIX TABLE SHOWN ON THIS SHEET.
- SLOPE TO RECEIVE TEMPORARY OR PERMANENT SEEDING SHALL HAVE THE SURFACE ROUGHENED BY MEANS OF TRACK-WALKING OR THE USE OF OTHER APPROVED IMPLEMENTS. SURFACE ROUGHENING IMPROVES SEED BEDDING AND REDUCES RUN-OFF VELOCITY.
- LONG TERM SLOPE STABILIZATION MEASURES SHALL INCLUDE THE ESTABLISHMENT OF PERMANENT VEGETATIVE COVER VIA SEEDING WITH APPROVED MIX AND APPLICATION RATE.
- ALL INLET PROTECTION MEASURES ARE TO BE REGULARLY INSPECTED AND MAINTAINED AS NEEDED.
- SATURATED MATERIALS THAT ARE HAULED OFF-SITE MUST BE TRANSPORTED IN WATER-TIGHT TRUCKS TO ELIMINATE SPILLAGE OF SEDIMENT AND SEDIMENT-LADEN WATER.
- SWEEPINGS FROM EXPOSED AGGREGATE CONCRETE SHALL NOT BE TRANSFERRED TO THE STORM WATER FACILITIES. SWEEPINGS SHALL BE PICKED UP AND DISPOSED IN THE TRASH.
- USE BMPs SUCH AS CHECK-DAMS, BERMS, AND INLET PROTECTION TO PREVENT RUN-OFF FROM REACHING DISCHARGE POINTS.
- ROUTINE MAINTENANCE SPECIFICATIONS FOR PERIMETER CONTROLS DOCUMENTED IN THE EPSCP MUST INCLUDE SECTIONS 2.1.4, 2.1.5 AND 2.2.6 OF THE GENERAL PERMIT NPDES CONSTRUCTION STORMWATER DISCHARGE PERMIT.
- CONTRACTOR SHALL COORDINATE WITH EPSC CERTIFIED VISUAL MONITORING INSPECTOR TO DETERMINE FINAL BMP TYPE AND PLACEMENT.
- STABILIZE EXPOSED SOIL AFTER EXCAVATION AND PRIOR TO PLACEMENT OF GRAVEL WITH STRAW MULCH, HYDROSEED, OR APPROVED ALTERNATE. SEE SEED MIX NOTES.
- ENSURE THAT PERMANENT SEEDING IS DONE WITHIN THE TIME FRAMES SET IN SECTION 01030 (SEEDING) OF THE OREGON STANDARD SPECIFICATIONS FOR CONSTRUCTION 2024.
- CONSTRUCTION WILL OCCUR DURING SUMMER MONTHS. DEWATERING IS NOT EXPECTED TO OCCUR. IF DEWATERING IS REQUIRED, DISCHARGE WATER TO ESTABLISHED VEGETATION IN UPLAND AREA.

TEMPORARY AND PERMANENT SEED MIX NOTES

CONTRACTOR TO USE SUNMARK NATIVE EC MIX, AS NEEDED, FOR EXPOSED SOIL IN ALL GRADING AREAS UNTIL FINAL GRAVELED SURFACE IS PLACED. APPLY STRAW MULCH, OR APPROVED ALTERNATE FOR TEMPORARY STABILIZATION TO THE SEEDED AREA.

SEEDING RATE: 1 PLS LBS. PER 1000 SQ. FT.
43.63 PLS LBS. PER ACRE

BOTANICAL NAME	NATIVE EC MIX COMMON NAME	% BY WEIGHT
HORDEUM BRACHYANTHERUM	MEADOW BARLEY	40%
BROMUS CARINATUS	CALIFORNIA BROME	35%
FESTUCA RUBRA	NATIVE RED FESCUE	20%
DESCHAMPSIA CESPITOSA	TUFTED HAIRGRASS	3%
AGROSTIS EXERATA	SPIKE BENTGRASS	2%
TOTAL		100%

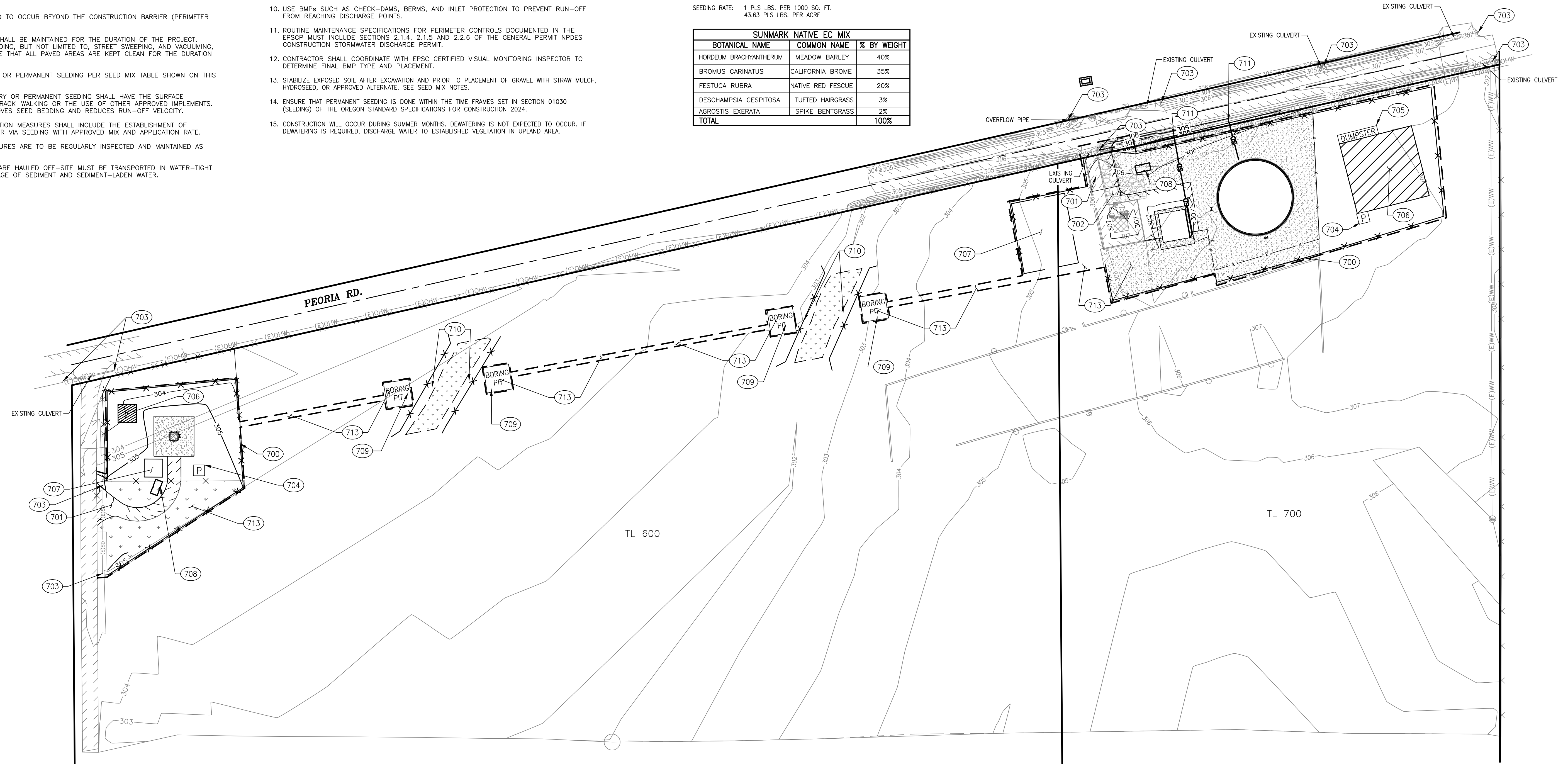

ESC CONSTRUCTION NOTES

- 700 INSTALL ORANGE SEDIMENT/CONSTRUCTION FENCE AT LIMITS OF DISTURBANCE WHERE NECESSARY TO LIMIT SEDIMENT DRAINING OUT FROM PROJECT SITE. INSTALLATION OF BMP PER OREGON STANDARD DRAWING RD1040, SEE SHEET EC400. REMOVE AFTER FINAL INSPECTION/APPROVAL.
- 701 USE EXISTING PAVED ACCESS AS CONSTRUCTION ENTRANCE/EXIT. ENSURE EXISTING ACCESS MEETS REQUIREMENTS SHOWN IN OREGON STANDARD DRAWING RD1000, SHEET EC400.
- 702 CONSTRUCT CONSTRUCTION ENTRANCE/EXIT TYPE 1 PER OREGON STANDARD DRAWING RD1000, SHEET EC400.
- 703 INSTALL TYPE 4 INLET PROTECTION FOR CULVERT INLETS PER OREGON STANDARD DRAWING RD1015, SHEET EC400. REMOVE AFTER LANDSCAPING VEGETATION IS ESTABLISHED.
- 704 PROVIDE AND MAINTAIN PORTABLE TOILETS PER OSHA STANDARDS. FINAL LOCATION TBD BY CONTRACTOR. REMOVE AFTER FINAL INSPECTION/APPROVAL.
- 705 PROVIDE DUMPSTER CONTAINERS FOR CONSTRUCTION DEBRIS. FINAL LOCATION TBD BY CONTRACTOR. REMOVE AFTER FINAL INSPECTION/APPROVAL.
- 706 TEMPORARY STOCKPILE LOCATION. INSTALL PLASTIC SHEETING ON STOCKPILE PER ODOT TECHNICAL SERVICES DETAIL DET6001, SHEET EC401. REMOVE AFTER FINAL INSPECTION/APPROVAL.

- 707 TEMPORARY AREA FOR EQUIPMENT AND MATERIAL STORAGE AND STAGING, STORAGE OF HAZARDOUS WASTE AND FUEL, AND EQUIPMENT REFUELING AND MAINTENANCE. SEE SPILL PREVENTION AND CONTROL NOTES ON SHEET EC000. REMOVE AFTER FINAL INSPECTION/APPROVAL.
- 708 CONSTRUCT CONCRETE TRUCK WASH OUT PER OREGON STANDARD DRAWING RD1070 ON SHEET EC401. REMOVE AFTER FINAL PAVING IS COMPLETE.
- 709 MATERIALS REMOVED OR EXCAVATED DURING BORING SHALL BE DEPOSITED AWAY FROM EXISTING WETLAND, AND EITHER RETURNED TO THE TRENCH AS BACK-FILL, OR IF OTHER MATERIAL IS TO BE USED AS BACK-FILL IN THE TRENCH, EXCESS MATERIALS SHALL BE IMMEDIATELY REMOVED FROM THE PROTECTED RESOURCE AND ITS ASSOCIATED BUFFER. SIDE-CASTING OF REMOVED MATERIAL INTO A THE EXISTING WETLAND SHALL NOT BE PERMITTED.
- 710 CONTRACTOR SHALL NOT DISTURB ANY AREA WITHIN 10' OF DELINEATED WETLAND BOUNDARY.
- 711 PROVIDE OUTLET PROTECTION. INSTALL RIPRAP PAD PER OREGON STANDARD DRAWING RD317 ON SHEET EC400.
- 713 HYDROSEED OR SEED ALL DISTURBED (CUT/FILL) AREAS PER SEED MIX NOTES AND TABLE SHOWN ON THIS SHEET (EXCLUDING ALL WEARING SURFACES). BORING PITS AND UTILITY TRENCHES SHALL BE BACKFILLED TO PRE-CONSTRUCTION GRADES, OR AS NOTED IN GRADING PLANS.

WET WEATHER REQUIREMENTS (OCT. 15TH - APR. 30TH)

- GRAVEL CONSTRUCTION SITE ENTRANCES TO PROTECT ADJOINING ROADS AND WATERWAYS FROM VEHICLE TRACKING OFF OF THE SITE.
- PROTECT ALL STORMWATER FACILITIES, WATER FEATURES AND NATURAL AREAS.
- SEDIMENT, SOIL, OR CONSTRUCTION-RELATED MATERIAL MUST BE REMOVED IMMEDIATELY FROM RIGHT-OF-WAY, ADJOINING PROPERTY AND NATURAL RESOURCES.

LEGEND

	EXISTING PROPERTY LINE		EROSION CONTROL
	EDGE OF ASPHALT		LIMITS OF DISTURBANCE
	FENCE		PROPOSED STAGING AREA
	BOTTOM OF DITCH		ORANGE SILT FENCE
	TOP OF BANK		PROPOSED STOCKPILE AREA
	BUILDING OR STRUCTURE		PROPOSED CONCRETE WASHOUT
	WATER METER		GRAVEL CONSTRUCTION ENTRANCE
	FIRE HYDRANT		
	WATER VALVE		
	POWER POLE		
	WASTE WATER MANHOLE		
	TELEPHONE RISER		
	GRAVEL		

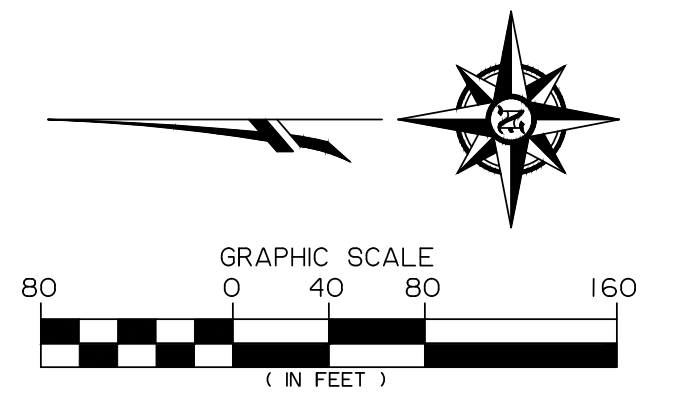

Z:\2020\20-006C Harrisburg WTP Site\1200-C\Drawings\20-006C_1200-C_Plan_L660324.dwg 6/4/2024 4:06 PM ZHARTAZ

NO.	DATE	BY	REVISION

NOTICE

0 1/2 1

IF THIS BAR DOES NOT MEASURE 1" THEN DRAWING IS NOT TO SCALE

JLL
DESIGNED
ZZ
DRAWN
DG
CHECKED

REGISTERED PROFESSIONAL ENGINEER
#86136PE
DIGITALLY SIGNED
OREGON
JULIE LYNN LELAND
JAN. 8. 2015
Expires: DEC 31, 2024

210 5th Street
Springfield, OR 97477
p: 541.746.0637
www.BranchEngineering.com

Established 1866

WTP DESIGN NORTH & SOUTH

TAX MAP: 15S04W04 TAX LOT: 600
TAX MAP: 15S04W09 TAX LOT: 700

**EPSCP: NORTH WTP SITE
FINAL LANDSCAPING
& SITE STABILIZATION**

PROJECT NO.: 20-0028.300 SCALE: AS SHOWN DATE: JUNE 2024

SHEET
EC300

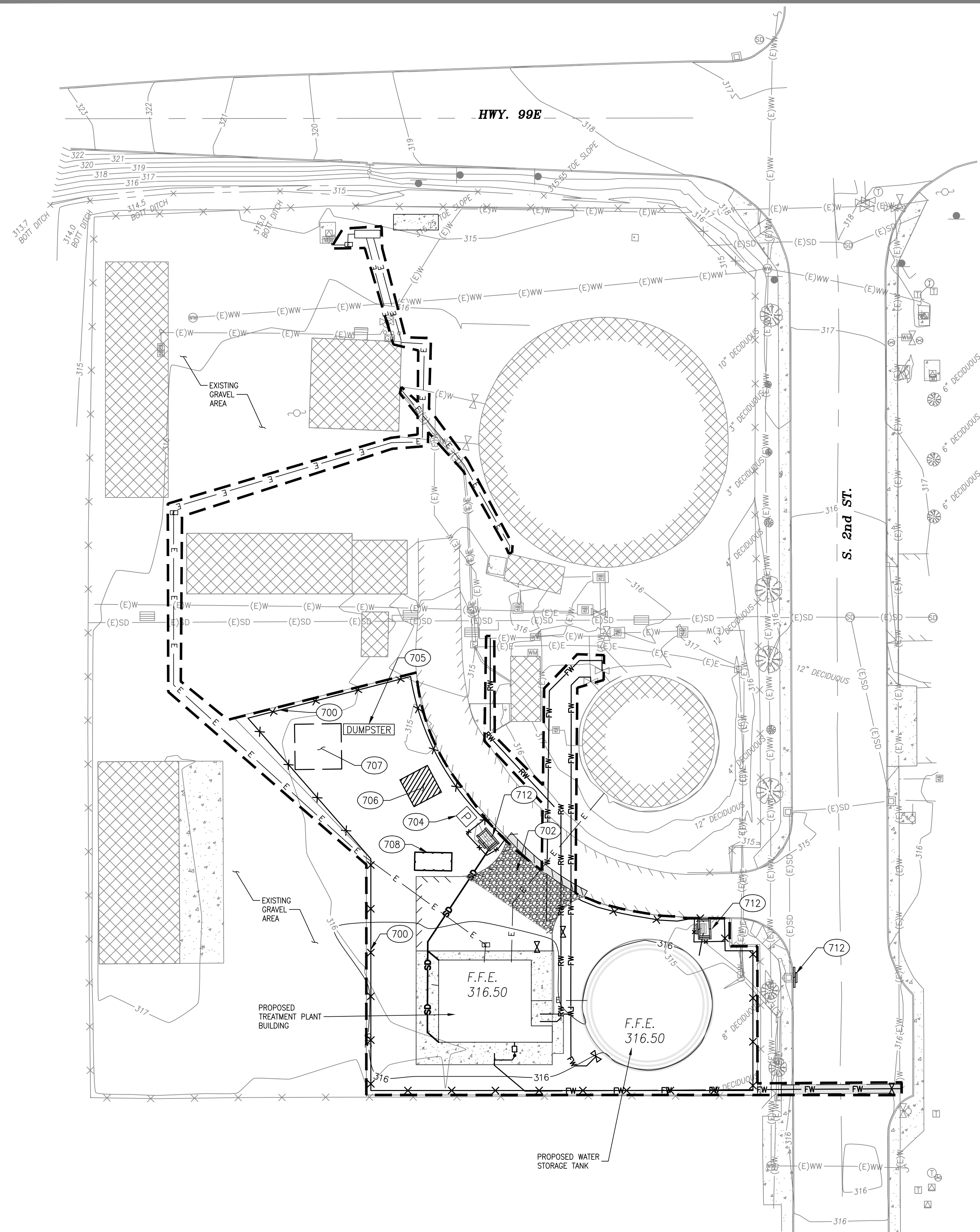

ESC CONSTRUCTION NOTES

- 700 INSTALL ORANGE SEDIMENT/CONSTRUCTION FENCE AT LIMITS OF DISTURBANCE WHERE NECESSARY TO LIMIT SEDIMENT DRAINING OUT FROM PROJECT SITE. CONTRACTOR TO COORDINATE WITH EPSC CERTIFIED VISUAL MONITORING INSPECTOR FOR FINAL PLACEMENT. INSTALLATION OF BMP PER OREGON STANDARD DRAWING RD1040, SEE SHEET EC400. REMOVE AFTER FINAL INSPECTION/APPROVAL.
- 702 CONSTRUCT CONSTRUCTION ENTRANCE/EXIT TYPE 1 PER OREGON STANDARD DRAWING RD1000, SHEET EC400.
- 704 PROVIDE AND MAINTAIN PORTABLE TOILETS PER OSHA STANDARDS. FINAL LOCATION TBD BY CONTRACTOR. REMOVE AFTER FINAL INSPECTION/APPROVAL.
- 705 PROVIDE DUMPSTER CONTAINERS FOR CONSTRUCTION DEBRIS. FINAL LOCATION TBD BY CONTRACTOR. REMOVE AFTER FINAL INSPECTION/APPROVAL.
- 706 TEMPORARY STOCKPILE LOCATION. INSTALL PLASTIC SHEETING ON STOCKPILE PER ODOT TECHNICAL SERVICES DETAIL DET6001, SHEET EC401. REMOVE AFTER FINAL INSPECTION/APPROVAL.
- 707 TEMPORARY AREA FOR EQUIPMENT AND MATERIAL STORAGE AND STAGING. STORAGE OF HAZARDOUS WASTE AND FUEL, AND EQUIPMENT REFUELING AND MAINTENANCE. SEE SPILL PREVENTION AND CONTROL NOTES ON SHEET EC000. REMOVE AFTER FINAL INSPECTION/APPROVAL.
- 708 CONSTRUCT CONCRETE TRUCK WASH OUT PER OREGON STANDARD DRAWING RD1015, SEE SHEET EC400. REMOVE AFTER FINAL LANDSCAPING VEGETATION IS ESTABLISHED.
- 712 INSTALL TYPE 4 INLET PROTECTION PER OREGON STANDARD DRAWING RD1015, SEE SHEET EC400. REMOVE AFTER FINAL LANDSCAPING VEGETATION IS ESTABLISHED.

FINAL LANDSCAPING AND SITE STABILIZATION GENERAL NOTES:

1. ALL BASE ESC MEASURES MUST BE IN PLACE, FUNCTIONAL, COMPLY WITH CURRENT ODOT SPECIFICATIONS, AND APPROVED IN AN INITIAL INSPECTION, PRIOR TO COMMENCEMENT OF CONSTRUCTION ACTIVITIES.
2. NO ACTIVITIES ARE PERMITTED TO OCCUR BEYOND THE CONSTRUCTION BARRIER (PERIMETER SEDIMENT FENCE).
3. ALL INLET PROTECTION MEASURES ARE TO BE REGULARLY INSPECTED AND MAINTAINED AS NEEDED.
4. SATURATED MATERIALS THAT ARE HAULED OFF-SITE MUST BE TRANSPORTED IN WATER-TIGHT TRUCKS TO ELIMINATE SPILLAGE OF SEDIMENT AND SEDIMENT-LADEN WATER.
5. SWEEPINGS FROM EXPOSED AGGREGATE CONCRETE SHALL NOT BE TRANSFERRED TO THE STORM WATER FACILITIES. SWEEPINGS SHALL BE PICKED UP AND DISPOSED IN THE TRASH.
6. USE BMPs SUCH AS CHECK-DAMS, BERMS, AND INLET PROTECTION TO PREVENT RUN-OFF FROM REACHING DISCHARGE POINTS.
7. STORM WATER FACILITIES SHALL BE CONSTRUCTED AND LANDSCAPED PRIOR TO THE STORM WATER SYSTEM FUNCTIONING.
8. ROUTINE MAINTENANCE SPECIFICATIONS FOR PERIMETER CONTROLS DOCUMENTED IN THE EPSCP MUST INCLUDE SECTIONS 2.1.4, 2.1.5 AND 2.2.6 OF THE GENERAL PERMIT NPDES CONSTRUCTION STORMWATER DISCHARGE PERMIT.
9. CONTRACTOR SHALL COORDINATE WITH EPSC CERTIFIED VISUAL MONITORING INSPECTOR TO DETERMINE FINAL BMP TYPE AND PLACEMENT.
10. CONSTRUCTION WILL OCCUR DURING SUMMER MONTHS. DEWATERING IS NOT EXPECTED TO OCCUR. IF DEWATERING IS REQUIRED, DISCHARGE WATER TO ESTABLISHED VEGETATION IN UPLAND AREA.

LEGEND

EXISTING		EROSION CONTROL	
	EDGE OF ASPHALT		LIMITS OF DISTURBANCE
	CONTOUR LINE		PROPOSED STAGING AREA
	FENCE		ORANGE SILT FENCE
	BOTTOM OF DITCH		PROPOSED STOCKPILE AREA
	BUILDING		PROPOSED CONCRETE WASHOUT
	CONCRETE		GRAVEL CONSTRUCTION ENTRANCE
	WATER VAULT		INLET PROTECTION
	WATER METER		
	FIRE HYDRANT		
	WATER VALVE		
	POWER POLE		
	STORM DRAIN MANHOLE		
	WASTE WATER MANHOLE		
	TRANSFORMER		
	ELECTRICAL VAULT		
	GAS METER		
	GAS VALVE		
	BOLLARD		
	TELEPHONE MANHOLE		
	TELEPHONE RISER		
	SIGN		

WET WEATHER REQUIREMENTS (OCT. 15TH - APR. 30TH)

1. GRAVEL CONSTRUCTION SITE ENTRANCES TO PROTECT ADJOINING ROADS AND WATERWAYS FROM VEHICLE TRACKING OFF OF THE SITE.
2. PROTECT ALL STORMWATER FACILITIES, WATER FEATURES AND NATURAL AREAS.
3. SEDIMENT, SOIL, OR CONSTRUCTION-RELATED MATERIAL MUST BE REMOVED IMMEDIATELY FROM RIGHT-OF-WAY, ADJOINING PROPERTY AND NATURAL RESOURCES.

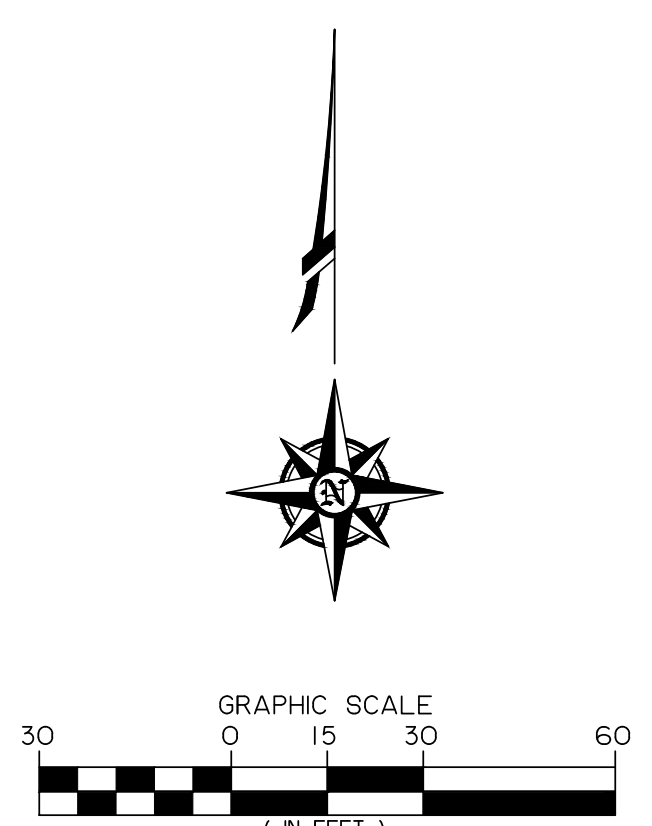

Z:\2020\20-006C Harrisburg WTP Site\1200-C Drawings\20-098C_1200-C PLAN_060324.dwg 6/4/2024 4:06 PM ZHARTAZ

NO.	DATE	BY	REVISION

NOTICE

IF THIS BAR DOES NOT MEASURE 1" THEN DRAWING IS NOT TO SCALE

JLL
DESIGNED
ZZ
DRAWN
DG
CHECKED

REGISTERED PROFESSIONAL ENGINEER
#86136PE
DIGITALLY SIGNED
OREGON
JAN. 8. 2010
JULIE LYNN LELAND
Expires: DEC 31, 2024

Branch ENGINEERING
Since 1977
210 5th Street
Springfield, OR 97477
p: 541.748.0637
www.BranchEngineering.com

WTP DESIGN NORTH & SOUTH
TAX MAP: 15S04W04 TAX LOT: 600
TAX MAP: 15S04W09 TAX LOT: 700

**EPSCP: SOUTH WTP SITE
FINAL LANDSCAPING
& SITE STABILIZATION**

PROJECT NO.: 20-0028.300 SCALE: AS SHOWN DATE: JUNE 2024

SHEET
EC301

RD1000.dgn 20-JAN-2021

CONSTRUCTION ENTRANCE - TYPE 1
NOT TO SCALE

CONSTRUCTION ENTRANCE - TYPE 2
NOT TO SCALE

CONSTRUCTION ENTRANCE - TYPE 3 (TYPE 1 OR 2 WITH EXISTING CURB)
NOT TO SCALE

WOODEN CURB RAMP SECTION D-D
NOT TO SCALE

CONSTRUCTION ENTRANCE TABLE
MINIMUM LENGTH

Length (FT)	Area Of Exposed Soil (Acre)
20	0.25
50	0.25 < A < 1.0
100	A > 1.0

NOTES:
1. The Type 1 entrance is a simple entrance without a diversion ridge or settling basin.
2. The wooden ramp may be used on either Type 1 or Type 2 entrances in situations where there is curb and the curb is not removed for the construction entrance.

GENERAL NOTES FOR ALL DETAILS:
1. See Std. Dwg's RD300 & RD304 for installation details.
2. Open ends of pipes normally require a site specific design, and may require special embankment protection, paved end slopes, safety end sections, or other measures. See special details or Standard Drawings as called for on plans.

OREGON STANDARD DRAWINGS
CONSTRUCTION ENTRANCES
2024
RD1000

Effective Date: June 1, 2024 – November 30, 2024

RD317.dgn 30-JUN-2022

SLOPED OR PROJECTING END

SLOPED END WITH SLOPE PAVING

HEADWALL AND WINGWALLS

EMBANKMENT PROTECTION

TABLE A - Embankment Slope Protection

Riprap Class	T Distance
50	12 inches
100	18 inches
200	24 inches +
700	30 inches +

TABLE B - Riprap Pad Dimensions

Riprap Class	L	T
50	48 or 1.3	2.3
100	48 or 1.6	3.3
200	48 or 2.0	4.3
700	48 or 3.3	5.6

GENERAL NOTES FOR ALL DETAILS:
1. Use must be approved by the engineer.
2. Not approved for use with sediment fencing with seam-in post sleeves.

OREGON STANDARD DRAWINGS
CULVERT EMBANKMENT PROTECTION AND RIPRAP PADS
2024
RD317

Effective Date: June 1, 2024 – November 30, 2024

RD1040.dgn 20-JAN-2021

PLAN DITCH INLET

PLAN AREA DRAIN

SECTION A-A DITCH INLET

PLAN CATCH BASIN

BIOFILTER BAGS - TYPE 4
NOT TO SCALE

NOTES:
1. Stake biofilter bags with 2"x2"x36" wood stakes, and use a minimum of 2 stakes per bag. Drive stakes a minimum of 6" into the ground and flush with the top of the bags.
2. Omit stakes when bags are placed on pavement surface.
3. Overlap all bag joints 6".
4. Biofilter bags used on active roadways are easily displaced and made ineffective if struck by vehicles. If struck by a vehicle, bags with injures could result. On active roadways alternative inlet protection should be considered.

OREGON STANDARD DRAWINGS
INLET PROTECTION TYPE 4
2024
RD1040

Effective Date: June 1, 2024 – November 30, 2024

RD1040.dgn 20-JAN-2021

FRONT VIEW

SECTION A-A

SEDIMENT FENCE AND GEOTEXTILE BURY DETAIL - TYPE 1
NOT TO SCALE

ALTERNATE SEDIMENT FENCE WITHOUT TRENCHING - TYPE 2
NOT TO SCALE

GENERAL NOTES:
1. Use 2"x2" wood fence posts.
2. Posts to be installed on downhill side of sediment fence geotextile. Position posts to prevent separation from geotextile.
3. Compact filter fabric trench backfill and soil on uphill side of fence.
4. Locate fence no closer than three feet to the toe of a slope.
5. Wing spacing shall comply with "Fence Spacing for General Application Table".

FENCE SPACING FOR GENERAL APPLICATION TABLE

GRADE	MAXIMUM SPACING ON GRADE
Grade < 10%	30'
10% < Grade < 15%	15'
15% < Grade < 20%	10'
20% < Grade < 30%	5'
> 30% < Grade	2.5'

POST SPACING TABLE

POST SPACING
6" Sediment Fence with Geotextile elongation less than 50%
4" Sediment Fence with Geotextile elongation 50% or more

OREGON STANDARD DRAWINGS
SEDIMENT FENCE
2024
RD1040

Effective Date: June 1, 2024 – November 30, 2024

Z:\2020\00-006C Harrisburg WTP Site\A\100-C\Drawings\20-098C_1200-4_Plan_L060324.dwg 6/1/2024 4:05 PM ZHARTAZ

NO.	DATE	BY	REVISION

NOTICE

IF THIS BAR DOES NOT MEASURE 1" THEN DRAWING IS NOT TO SCALE

JLL
DESIGNED
ZZ
DRAWN
DG
CHECKED

REGISTERED PROFESSIONAL ENGINEER
#86136PE
DIGITALLY SIGNED
OREGON
JULIE LYNN LELAND
JAN. 8. 2010

Expires: DEC 31, 2024

consor

Branch ENGINEERING
210 5th Street
Springfield, OR 97477
p: 541.748.0637
www.BranchEngineering.com

CITY OF HARRISBURG
Established 1866

WTP DESIGN NORTH & SOUTH
TAX MAP: 15S04W04 TAX LOT: 600
TAX MAP: 15S04W09 TAX LOT: 700

ESCP: DETAILS

PROJECT NO.: 20-0028.300 SCALE: AS SHOWN DATE: JUNE 2024

SHEET EC400

